

NOTE
1. THE SCHEME WAS DISCUSSED IN THE 255TH SCREENING COMMITTEE MEETING HELD ON 16-05-2007 VIDE ITEM NO. 103 & 2007 IN FILE NO. F.7 (42) [E] [R.D.] [D.D.] 07-2008.
-SD-
DIRECTOR (N.P.)

AREA STATEMENT

TOTAL SCHEME AREA	9.26 Ha
FACILITIES AREA	1.87 Ha
1. TRANSPORT & WARE HOUSING	4400 SQM
2. SERVICE & REPAIR	3210 SQM
3. FACILITIES	11100 SQM
POLICE POST	1600 SQM
DHARAMSHALA/NIGHT SHELTER	370 "
WEIGHT MACHINE/DHARMKANTA	700 "
FACILITIES PLOTS (4 NOS)	1600 "
M.C.D. GODOWN	2200 "
ADMN OFFICE	150 "
PETROL PUMP CUM CNG STATION	1620 @ 50M
PUBLIC CONVENIENCE/TOILET BL.	244 "
FOOD OUTLET/FOOD COURT	985 @ 50M
KESKS	711 "
ESS (4 NOS)	192 "
CIRCULATION	1.78 Ha
• I.D.L.E. PARKING	5.7128 Ha
PHASE I	2784 SQM
PHASE II	2064 SQM
L.M.V./CAR	9000 SQM

1. MODIFIED AS/ FEASIBILITY REPORT RECEIVED FROM EE ND/12
2. THIS DRG. SUPERCEDES DRG NO 357 DRG HAS BEEN REVISED AS FEASIBILITY RECEIVED FROM EE ND 12 VIDE LETTER NO F 31(9)33A, CB/ ND 12 D D A / 599 DT 25 8 96
3. FOR PART LAY OUT PLAN REFER DRG NO 358A.
5. D.D.S. 21-12-98
5. D.D.S. 21-12-98

NOTES
LAYOUT PLAN APPROVED IN 188 THE S.C. ON 12-8-97. VIDE ITEM NOS 5897/1895 S.C. THE MINOR MODIFICATIONS IN THE L.O.R HAS BEEN APPROVED BY AC (U.D.P. & B) VIDE ORDERS DATED 17-3-02 AT PAGE 4/N IN FILE NO F 15(3)2002/NP. ALL THE INFORMATION & EXISTING FEATURE HAS BEEN SUPPLIED BY EX ENGG (ND 12) AND THE SAME INCORPORATED IN THE DRG.

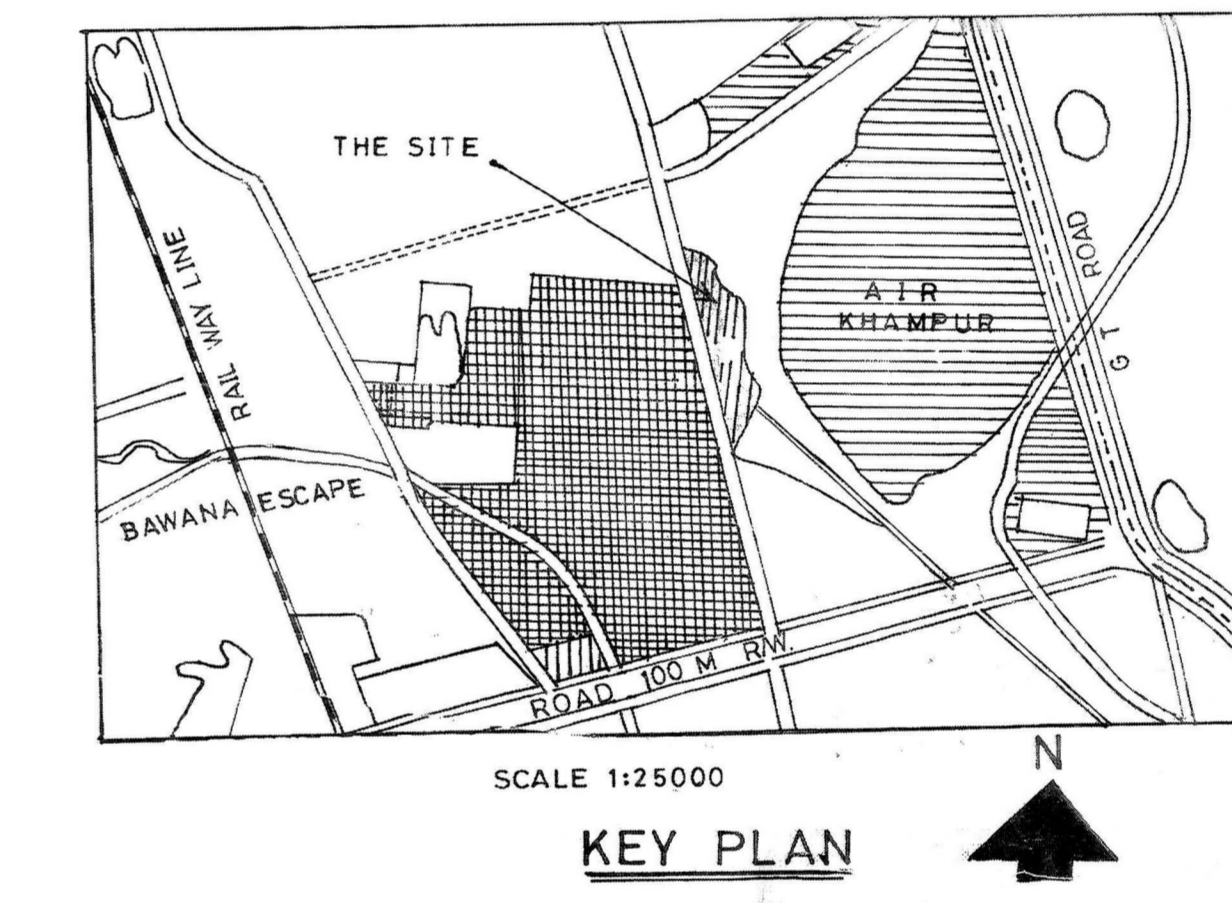
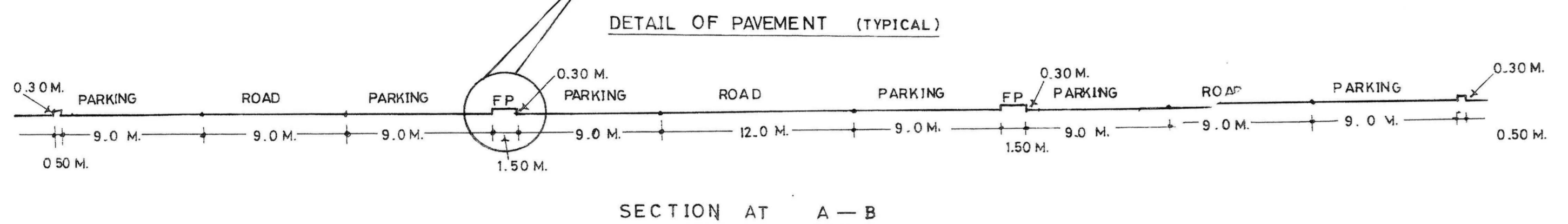
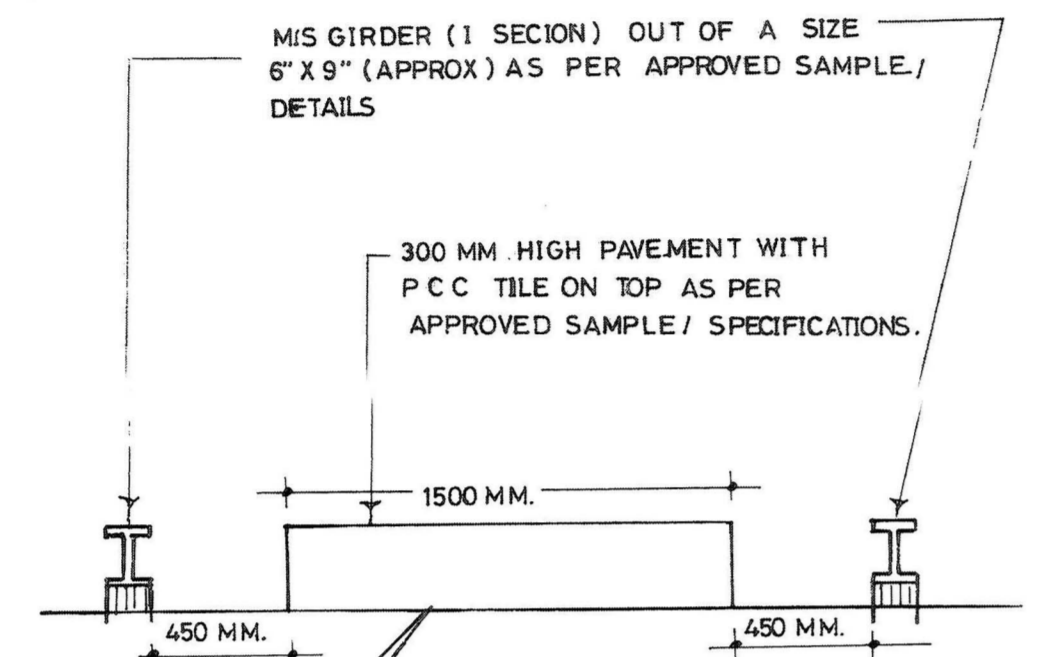

S.NO.	PLOT SIZE IN MTS	PLOT AREA IN SQ MTS	PLOT NO S	TOTAL PLOTS	PLOT USE
1	20.0x10.0	200.0	1106	12	SERVICE REPAIR
2	10.0x5.0	50.0	71014	47	
3	10.0x15.0	150.0	16 21 23 23 35 38 40 45	24	TRANSIT / WARE HOUSING
4	20.0x20.0	400.0	15 22 38 45	4	FACILITIES
5	20.0x20.0	400.0	29 32	4	
6	ODD PLOT	700.0	64	1	FACILITIES
7	ODD PLOT	970.0	65	1	DO
8	ODD PLOT	1600.0	66	1	DO

PLOT NOS	MAX GRD COVERAGE	FAR	MAX. HT.	REMARK
1 TO 28	50%	20%	11 M	BASEMENT PERMITTED. COULDN'T BE A.R.A.
33 TO 60				
29 TO 32	50%	20%	16 M	BASEMENT NOT
61 TO 63	36.0 SQM	36	4.0 M	PERMITTED
64	20.0 SQM	36	4.0 M	DO
65	33.33%	75	15M	AS PER M.P.D. 2001.
66	35%	70	14 M	DO

NOTES
THE MODIFIED PLAN OF TRUCK TERMINAL AT I.F.C WAS DISCUSSED IN THE 255TH SCREENING COMMITTEE HELD ON 16-05-2007 VIDE ITEM NO. 103 & 2007 IN FILE NO. F.7 (42) [E] [R.D.] [D.D.] 07-2008.
THE MODIFIED PROPOSAL WAS CONSIDERED IN THE 255TH SCREENING COMMITTEE MEETING HELD ON 16-05-2007 VIDE ITEM NO. 103 & 2007 BY DIRECTOR (ARCH) COORD.
DETAILED PLAN OF AREA TO BE PREPARED BY THE HUPV WHICH SHALL ALSO INCLUDE INCREASING THE NUMBER OF FOOD OUTLETS / PROVISION OF FOOD COURT.
THE MODIFICATION IN THE PLAN MARKED 'X' IS INCORPORATED AS APPROVED BY COMM. PLG. NOTE 21/25/02 DT 02. AT RISE WITH FILE NO. F.45(ND) 2002/NP.

DELHI DEVELOPMENT AUTHORITY
HUPV COORDINATION UNIT
VERIFIED
APPROVED IN 255TH SCREENING COMMITTEE HELD ON 16-05-2007 VIDE ITEM NO. 36 (2007) WITH THE OBSERVATION THAT THE CHIEF ENGINEER (ELECTRICAL) TO CONFIRM THAT FURTHER INCREASE IN HEIGHT OR REARMAMENT OF THE H.T. Pylon WILL NOT BE REQUIRED IN THE FUTURE.
-SD-
DIRECTOR (N.P.)

DELHI DEVELOPMENT AUTHORITY
CERTIFIED
APPROVED IN 257TH SCREENING COMMITTEE MEETING HELD ON 01.09.2006 VIDE ITEM NO. 021 OF ALL OBSERVATION (01.02.07) INCORPORATED.
-SD-
DIRECTOR (N.P.)

MODIFIED LAYOUT PLAN OF TRUCK TERMINAL AT I.F.C NARELA SUB-CITY.

Scale: 1:500
Date: 05-04
Drawn by: R.K. SAINI, S. PRASAD, P. SASTRI
Checked by: R.K. JAIN, S. D. SINGH
Project: NARELA PROJECT
Drawing No: 442
NARELA परियोजना



TO G.T. ROAD / NARELA PH-1
ROAD 60.0 MT WIDE
TO 100.0 MT WIDE EXPRESS WAY